

## Overview

without PCI Expansion Module

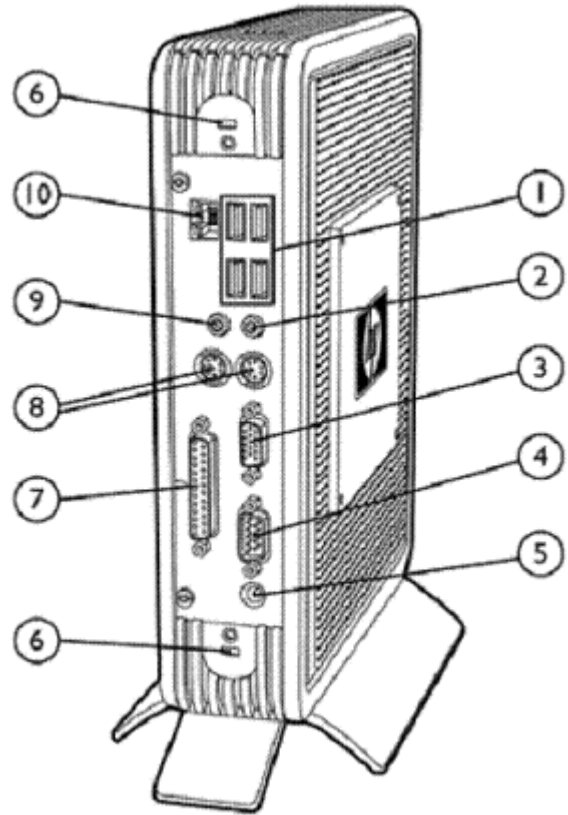
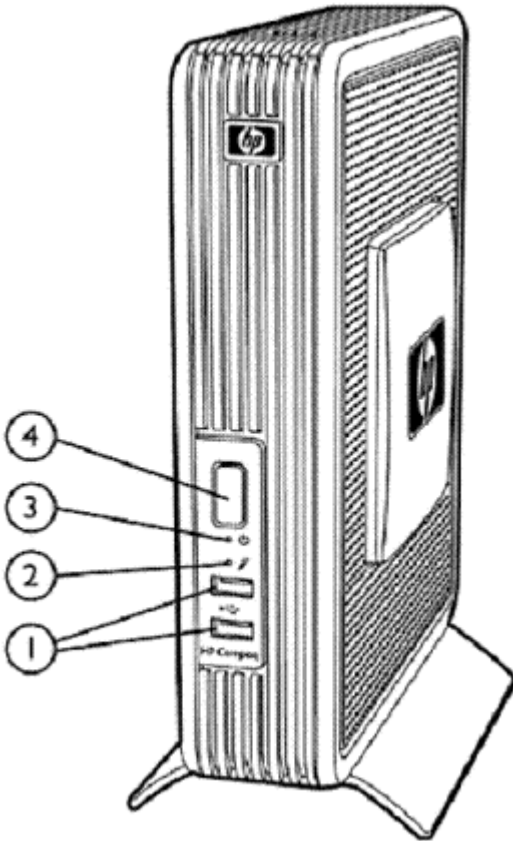

1. USB connectors, 2 front
2. Flash activity LED
3. Power LED
4. Power button

1. USB connectors, 4 rear
2. Line-in audio connector
3. Monitor connector
4. Serial connector
5. Power connector
6. Cable lock slots
7. Parallel connector
8. PS/2 connectors (2)
9. Line-out audio (headphone) connector
10. Ethernet RJ-45 connector

## Overview

with PCI Expansion Module

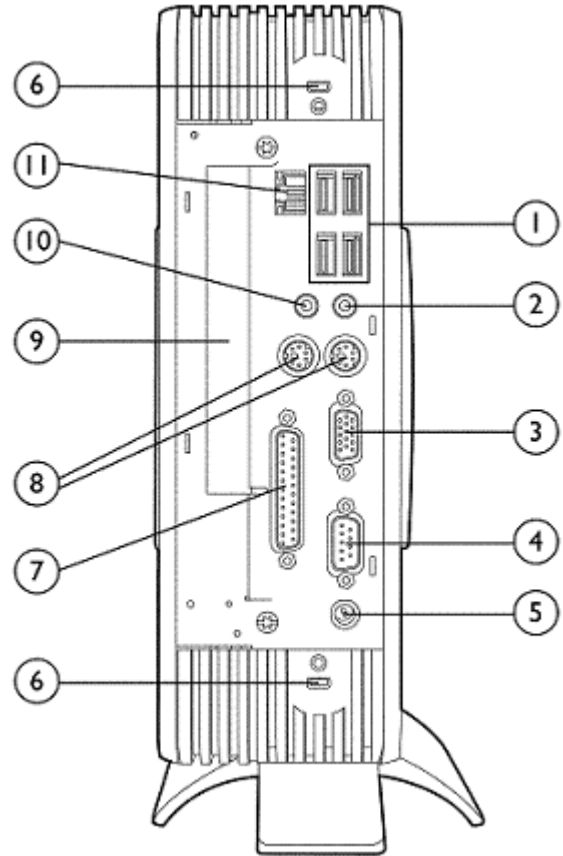
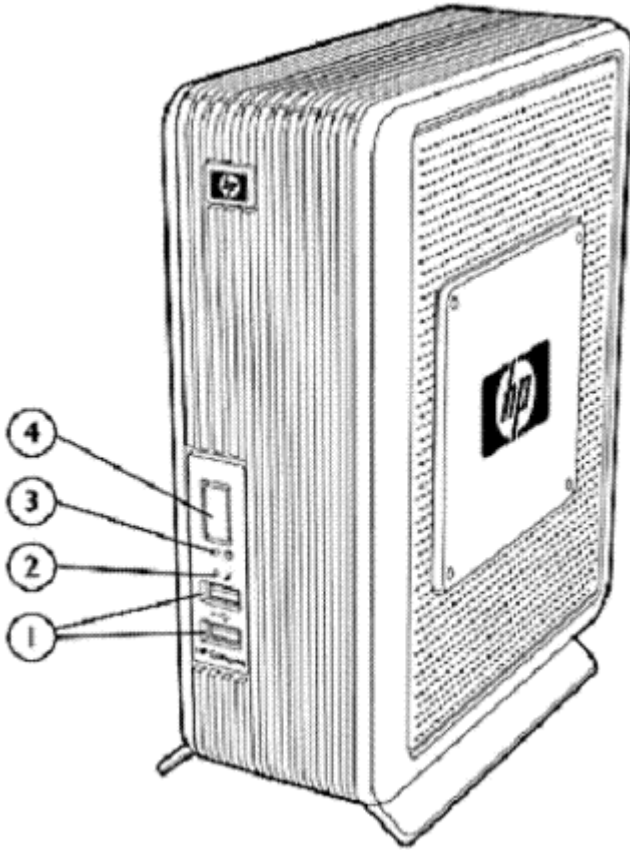

1. USB connectors, 2 front
2. Flash activity LED
3. Power LED
4. Power button

1. USB connectors, 4 rear
2. Line-in audio connector (microphone)
3. Monitor connector
4. Serial connector
5. Power connector
6. Cable lock slots
7. Parallel connector
8. PS/2 connectors (2)
9. PCI access slot
10. Line-out audio (headphone) connector
11. Ethernet RJ-45 connector

## Overview

### At A Glance

- Simplified IT management for the enterprise and SMB
- HP's "Anywhere Thin Client" with the innovative HP Quick Release
- Microsoft® Windows® XP Embedded operating system SP2
- Desktop-like features at compelling prices
- Lower ownership costs and increased resource efficiency for each end-user
- Now with HP's innovative ThinState Capture and Deploy for easy USB Flash key image capture and redeploy
- AMD Geode NX 1500 processor
- SiS741GX Integrated/UMA graphics with 16 MB shared graphics memory
- Support for up to 1 GB MB of Flash and up to 512 MB DDR SDRAM memory
- Optional PCI Expansion Module
- Protected by Hewlett-Packard Services, including a limited three-year mail-in warranty (certain restrictions and exclusions apply)
- HP Sygate Security Agent pre-installed

### Overview - PCI Expansion Module Kit

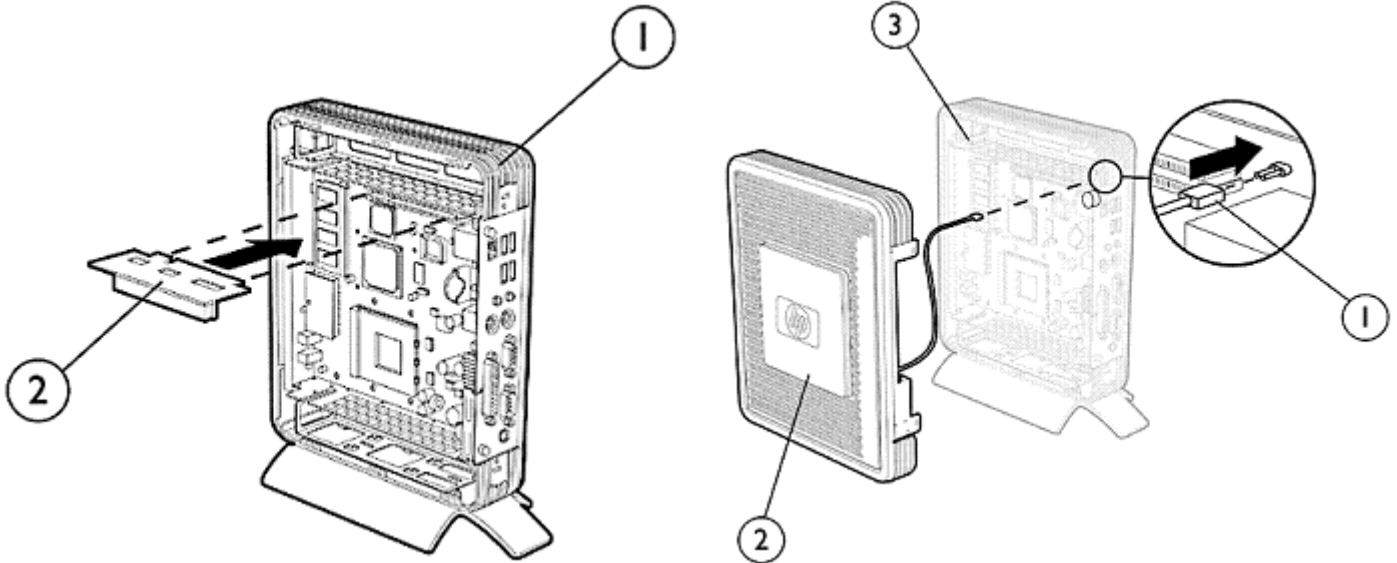

1. HP Compaq t5720 with cover removed
2. PCI Expansion Module Riser card being inserted into the t5720 thin client unit

1. HP Compaq t5720 with cover removed
2. HP Compaq t5720 PCI Expansion Module cover with audio cable
3. Diagram of audio cable being inserted into t5720 system board

## Models

Part Number: EK530AA

## Introduction

The PCI Expansion Module for the HP Compaq t5720 allows for optional PCI devices including wireless networking cards (802.11 b/g), dial up modems, additional graphics, network, and input/output options.

## Compatibility

HP Compaq t5720 PCI Expansion Module is designed to integrate with HP Compaq t5720 Thin Client to accommodate full-height, ½ length PCI card. Refer to the HP t5720 QuickSpecs for HP supported devices.

## Overview - PCI Expansion Module Kit

### Restrictions

Do not orient the HP Compaq t5720 Thin Client with the PCI Expansion Module in the horizontal, upside down mode (see figure below) as the unit may overheat. All other orientations are acceptable.



---

### Service and Support

The HP Compaq PCI Expansion Module has a one-year limited warranty. Technical support is available seven days a week, 24 hours a day, by phone, as well as online support forums. Certain restrictions and exclusions apply.

### Standard Features - Models

EG840AA#XXX	Processor	AMD Geode NX 1500 processor (1.0 GHz)	
	Operating System	Microsoft Windows XP Embedded, Service Pack 2	
	Flash Memory	512 MB	
	Memory	512 MB DDR SDRAM <b>NOTE:</b> 16 MB of system RAM is reserved for graphics memory.	
	Graphics	SiS741GX Integrated/UMA graphics with 16 MB shared graphics memory	
	PCI Expansion	Yes	
	Browser	Microsoft Internet Explorer 6.0	
	Client Management Software	Altiris Deployment Solution license and ThinState Capture and Deploy at no additional charge with each client. HP OpenView Client Configuration Manager support available.	
	Terminal Personalities Standard	Yes	
	Keyboard	USB or PS/2 (both supported) Keyboard included with every thin client. Type of included keyboard (USB or PS/2) varies by region.	
	Mouse	USB or PS/2 (both supported) Mouse included with every thin client. Type of included mouse (USB or PS/2) varies by region.	

AH462AA#ABA (TAA compliant) <sup>1*</sup>	Processor	AMD Geode NX 1500	
	Operating System	Microsoft Windows XP Embedded, Service Pack 2	
	Flash Memory	1 GB	
	Memory	1 GB DDR SDRAM <b>NOTE:</b> 16 MB of system RAM is reserved for graphics memory.	
	Graphics	SiS741GX Integrated/UMA graphics with 16 MB shared graphics memory	
	PCI Expansion	Yes	
	Browser	Microsoft Internet Explorer 6.0	
	Client Management Software	Altiris Deployment Solution license and ThinState Capture and Deploy at no additional charge with each client. HP OpenView Client Configuration Manager support available.	
	Terminal Personalities Standard	Yes	
	Keyboard	USB or PS/2 (both supported) Keyboard included with every thin client. Type of included keyboard (USB or PS/2) varies by region.	
	Mouse	USB or PS/2 (both supported) Mouse included with every thin client. Type of included mouse (USB or PS/2) varies by region.	

<sup>1</sup>Product complies with U.S. Trade Agreement Act (TAA). Available in U.S. only.

### Options

		Part Number
<b>Accessories</b>	t5700 40W AC Adapter	DZ991A
	HP t5720/t5725 PCI Expansion Module	EK530AA
	HP Quick Release Kit	EM870AA
	HP/Kensington Cable Lock	PC766A
	50 Watt External Power Supply	FJ851AA
<b>Communications</b>	Ethernet Bridge – Linksys Wireless-G Ethernet Bridge	WET54G
	Ethernet Bridge – Linksys Wireless-G Ethernet Bridge	WET54GS5
	Modem Serial – Zoom 3049 56K v.92 Ext. Modem - Serial	3049-00-00
	Modem USB – Zoom 2985C USB 56K v.90 External Modem	2985-00-00C
	Modem PCI – Agere 2006 PCI Hi-Speed 56K Sof	EK694AA
	Wireless PCI – Cisco Aironet PCI	AIR-PI21AG-A-K9
	Wireless PCI – HP Wireless A+G PCI Adapter (North America Only)	EA118AA
Wireless PCI – HP Wireless A+G PCI Adapter (Worldwide - except North America)	PZ928AA	
<b>Connectivity</b>	HP PS/2 Standard Keyboard	DT527A
	HP USB Standard Keyboard	DT528A
	HP USB Smartcard Keyboard	ED707AA
	HP PS/2 2-Button Scroll Mouse	DD440B
	HP PS/2 2-Button Optical Mouse	EY703AA
	HP USB 2-Button Optical Scroll Mouse	DC172B
	HP Belkin USB To Serial Adapter	EM449AA
<b>Monitors</b>	ELO Touch 1529L Flat Panel – USB /serial combo <sup>1</sup>	E926109
	ELO Touch 1515L Flat Panel – USB/serial combo <sup>1</sup>	E849124
	ELO Touch 1725C CRT – USB/serial combo <sup>1</sup>	E248189
	ELO Touch 1526C CRT – USB/serial combo <sup>1</sup>	E833965
<b>Graphics</b>	NVIDIA Quadro 280nvs 64 MB PCI Dual Head	DY599A
	Matrox EpicA TC4	EPI-TC4P128LPAF
	Matrox EpicA TC2	EPI-TC2P64LPAF
<b>Memory</b>	512 MB DDR SDRAM (333 MHz) Memory	EK692AA
	1024 MB 333 MHz DDR	DC890B
	1 GB Flash Module	AH430AA

### Options

<b>Security</b>	HP USB Smartcard Keyboard	ED707AA
	Digital Privacy SCR331 USB Smart Card Reader <sup>1</sup>	904054
	Envoy Data SCR331 USB Smart Card Reader <sup>1</sup>	904054
	TxSystems SCR331 USB Smart Card Reader <sup>1</sup>	904054
	HP/Kensington Cable Lock	PC766A
<hr/>		
<b>Storage</b>	Apacer 1 GB Disk on Key (DOK) <sup>1</sup>	AP-HHR100HD2
	Apacer 512 MB Disk on Key (DOK) <sup>1</sup>	AP-HHR512HD2
	HP Driverless USB Diskette Drive	F5101B
	External USB 2.0 Multibay II Cradle	PA509A
	HDD Multibay II 80 GB 5400rpm	PH357A
	Multibay II DVD Drive (Does not support DVD play back)	PA849A
<hr/>		
<b>Care Packs</b>	9x5 Next-Business-Day <sup>2</sup> Advanced Exchange - 3 Years	331653-001; U4847E <sup>3</sup>
	9x5 Next-Business-Day <sup>2</sup> On-Site Coverage - 3 Years	331655-001; U4849E <sup>3</sup>
	Hardware Installation	331686-001; U4865E

<sup>1</sup>Option available directly from third party.

<sup>2</sup>Service levels and response times for HP Care Packs may vary depending on your geographic location. Restrictions and limitations apply. For details, visit [www.hp.com/go/carepack](http://www.hp.com/go/carepack).

<sup>3</sup>U4847E is available in all regions; U4849E is available in Americas and Asia-Pacific/Japan.



## Memory

### Possible Memory Configurations

Flash Memory	Memory Slot (DDR SDRAM)
512 MB	256 MB
512 MB	512 MB
1 GB	512 MB
1 GB	1 GB

### Technical Specifications

System Unit	Processor	AMD Geode NX 1500 (1.0 GHz)		
	Memory	Flash Memory	512 MB, 1 GB	
		System Memory	256 MB, 512 MB, or 1 GB DDR SDRAM <b>NOTE:</b> 16 MB of system RAM is reserved for graphics memory	
	Graphics	SiS741 GX Integrated/UMA graphics with 16 MB of shared graphics memory		
		<b>Mode</b>	<b>Refresh Rates</b>	<b>Color Depth</b>
		640 x 480	60–200 Hz	8/16/32-bit
		800 x 600	60–160 Hz	8/16/32-bit
		1024 x 768	60–120 Hz	8/16/32-bit
		1152 X 864	60–85 Hz	8/16/32-bit
		1280 x 1024	60–85 Hz	8/16/32-bit
		1600 x 1200	60–85 Hz	8/16/32-bit
		1920 x 1200	60 Hz	8/16/32-bit
		1920 x 1440	60–85 Hz	8/16/32-bit
		2048 x 1536	60–75 Hz	8/16/32-bit
	Input/Output/ Peripheral Support	<b>Keyboard</b>	HP PS/2 Standard Keyboard	
		<b>Mouse</b>	Two button scroll, PS/2	
		<b>Printer</b>	Local and/or network printers (RDP, ICA, LPD) as per the printer support statement	
		<b>Video</b>	SiS74iGX Integrated/UMA graphics with 16 MB shared graphics memory	
	Audio	<b>Output</b>	Internal amplified speaker, 1/8-inch mini, full 16-bit stereo, 44-kHz sample rate	
		<b>Input</b>	1/8-inch mini microphone	
	Security	Two security lock slots (cable lock sold separately) HP Sygate Security Agent		
	Terminal Server Protocols	Integrated Microsoft RDP 5.2 and Citrix ICA 9.15. Terminal personalities standard		
	Networking	10/100 BaseT Fast Ethernet, twisted pair (RJ-45)		
		TCP/IP with DNS and DHCP		
		Point-to-Point Protocol (PPP), Direct Connection through RS-232, Point-to-Point over Ethernet (PPPoE),		
		Point-to-Point Tunneling Protocol (PPTP), Layer-2 Tunneling Protocol (L2TP), Wake on LAN (WOL), PXE		
		Server Network Time Protocol (SNTP)		
		Simple Network Management Protocol (SNMP)		
	I/O ports and connectors	Six USB ports (2 front/4 rear), 1 serial, 1 parallel, RJ-45, 1 PCI expansion, 2 PS/2		
	Resident Operating System	Microsoft Windows XP Embedded, Service Pack 2		

### Technical Specifications

<b>Session Allocation Managers/Session Brokers</b>	HP PC Session Allocation Manager Software for the Consolidated Client Infrastructure, Citrix Desktop Broker for Virtual Desktop Infrastructure	
<b>Server OS Compatibility/Support</b>	Microsoft Windows NT 4.0 Server, Windows NT 4.0 Terminal Server Edition, Windows 2000/2003 Server families, Windows 2000/2003 Server Terminal Services, Windows 2000 Advanced Server, Windows 2000 Advance Server Terminal Services, Citrix Presentation Server 4.0 including the Desktop Broker feature, Citrix Metaframe Presentation Server 3.0, Citrix Metaframe XP Presentation Server, Citrix Metaframe 1.x, and VMware Virtual Desktop Infrastructure using RDP.	
<b>Software Included</b>	<p>Microsoft Windows XP Embedded preinstalled            Microsoft Internet Explorer 6.0 preinstalled            HP Sygate Security Agent            Altiris Deployment Solution (client agent) preinstalled. Altiris Deployment Solution 6.5 (management console) available as free download from Altiris at: <a href="http://www.altiris.com/hptc">http://www.altiris.com/hptc</a>            HP ThinState Capture and Deploy for easy USB Flash key image capture and redeploy            Terminal Emulation Software, Citrix ICA, and RDP            Windows Media Player 9            Other software available as add-ons (see <a href="http://www.hp.com/support">http://www.hp.com/support</a> for latest list of available add-ons)</p>	
<b>Languages</b>	English	
<b>Dimensions H x W x D (approximate)</b>	<b>Without stand</b>	9.85 x 2.59 x 8.09 in (250.18 x 65.78 x 205.48 mm)
	<b>With stand</b>	10.67 x 4.33 x 9.33 in (271.09 x 110 x 237.1 mm)
	<b>With PCI Expansion Module</b>	9.85 x 3.6 x 8.09 in (250.18 x 87.4 x 205.48 mm)
<b>Weight (approximate)</b>	<b>With stand</b>	3.7 lbs (1.7 kg)
	<b>With PCI Expansion Module</b>	4.5 lbs (2 kg)
<b>Environmental</b>	<b>Temperature range on</b>	50° to 104° F (10° to 40° C)
	<b>Temperature range on when using the Quick Release with a flat panel monitor or PCI expander</b>	50° to 95° F (10° to 35° C)
	<b>Temperature range off</b>	-22° to 140° F (-30° to 60° C)
	<b>Humidity</b>	20% to 80% condensing 10% to 95% non-condensing
	<b>Power*</b>	Worldwide auto-sensing 100-240 VAC, 50-60 Hz energy-saving automatic power-down. Average power consumption of this thin client in a typical setup is 20.1W.

\* The actual power consumption at your location could vary and is dependent on many factors including but not limited to software load on the thin client, attached peripherals, and environmental factors.

## Technical Specifications

Regulatory Compliance	<b>Ergonomics</b> <b>Safety</b>	German ZH1/618; EN29241-3, approved UL 1950, CSA 950; TÜV-GS (EN60 950) approved
Warranty	<b>RF Interference</b> Three-year limited hardware warranty. <b>NOTE:</b> <a href="#">Certain restrictions apply. Consult the HP Customer Support Center for details.</a>	FCC Class B; CE Mark; EN55022B; VCCI
Emulations	<b>Emulation</b> ADDS A2 AIXTerm ANSI BBS AT 386 ATT4410 DG 410/412 HP 700-92/96 HZ1500 IBM3151 IBM3270  IBM5250  SCO Console Stratus V102 TA6530 TVI910 TVI920 TVI925 TVI950 TVI955 VT52, VT100, VT100+, VT500 (7- or 8-bit)  VT HP220, VT UTF8  VT PCTerm Wyse PCTerm	<b>Terminal ID</b>  70092, 70094, 70096, 2392A, 2622A  Mod11, Mod31 3278-2 (24x80), 3278-3 (32x80), 3278-4 (43x80), 3278-5 (27x132), 3278-2-E (24x80), 3278-3-E (32x80), 3278-4- E (43x80), 3278-5-E (27x132), 3279-2 (24x80), 3279-3 (32x80), 3279-4 (43x80), 3279-5 (27x132), 3287-1  5291-1, 5292-2, 5251-11, 3179-2, 3196-A1, 3180-2, 3477-FC (27x132), 3477-FG (24x80), 3486-BA, 3487-HA, 3487- HC, 3812-1  VT100, VT101, VT102, VT125, VT131, VT132, M2200, VT220, VT240, VT320, VT340, VT420, VT510, VT520, VT525  VT100, VT101, VT102, VT125, VT220, VT240, VT320, VT340, VT420, VT131, VT132, M2200, VT510, VT520, VT525



### Technical Specifications

WY50  
WY50+  
WY60

---

<b>PCI Expansion Module Kit</b> (installed on unit)	<b>Mechanical</b>	<b>Dimensions (H x W x D)</b>	Installed on unit	9.85 x 3.44 x 8.09 in (250.18 mm x 87.26 mm x 205.55 mm)
		<b>Approximate Weight</b>	Installed on unit	4.5 lb (2.0 kg)
	<b>Temperature Range</b>	<b>Operating</b>	50° to 95° F (10° to 35° C)	
		<b>Non-operating</b>	-22° to 140° F (-30° to 60° C)	
	<b>AC Adapter (50W)</b> (included in kit)	<b>Input</b>	100-240V, 1.5A/50 60Hz	
		<b>Output</b>	12V, 4.16A, 50W	

Specifications are at sea level with altitude derating of 1.8° F/1000 ft (1° C/300 m) to a maximum of 10,000 ft (3 Km), with no direct, sustained sunlight. Upper limit may be limited by the type and number of options installed.

---

© 2009 Hewlett-Packard Development Company, L.P.

Microsoft, Windows, and Windows NT are trademarks or registered trademarks of Microsoft Corporation in the United States and other countries. AMD and Geode are trademarks of Advanced Micro Devices, Inc.

The information contained herein is subject to change without notice and is provided "as is" without warranty of any kind. The warranties for HP products and services are set forth in the express limited warranty statements accompanying such products and services. Nothing herein should be construed as constituting an additional warranty. HP shall not be liable for technical or editorial errors or omissions contained herein.